

# ONDA 800 ONDA 801

**Gear motor  
for sliding gates.**

**Condominium use up to 500 kg.**

**Residential use up to 800 kg.**



Reduced noise level and maximum performance for condominium use.

Maximum reliability thanks to the steel gears and permanent system lubrication.

Maximum safety thanks to the electronic torque adjustment function.

## TECHNICAL DETAILS

The gear motor cannot be reversed and therefore keeps the gate locked. The use of other lock systems is therefore eliminated.

Manual key release in the event of mains power supply failure.

Check that the lower gate wheels are not too small for the weight of the structure (the minimum diameter of the wheels is 120 mm).

T22 electronic control unit on board and built-in Unico Memory System radio receiver (super-heterodyne version)

## TECHNICAL DATA

## ONDA 800/801

POWER SUPPLY	230 V 50 Hz
POWER ABSORBED	260 W
CURRENT ABSORBED	1.6 A
OVERLOAD TEMP.	90° C
OPERATING TEMPERATURE	-20°/+70° C
WEIGHT	10 kg
LUBRICANT TYPE	AprimGREASE Vc 84
LINEAR SPEED	9.5 m/min (Z16) 12.0 m/min (Z20).
THRUST FORCE	85 da. N (Z16) 68 da. N (Z20)
MAX. WING WEIGHT	800 kg
PROTECTION RATING	IP 44



SLIDING GATES

## OPERATOR DIMENSIONS

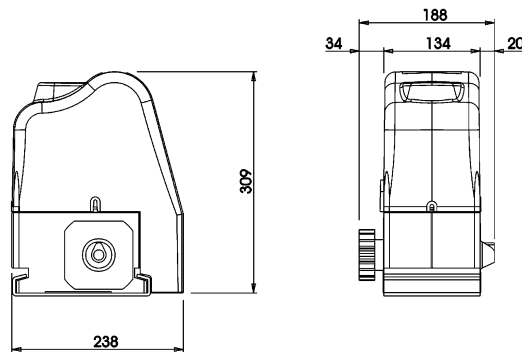

DESCRIPTION	Weight max	CODE
<b>ONDA 800 (Z16)</b> Gear motor with built in T2E control unit. With mechanical duth.	500 kg uso resid 300 kg uso cond	668400000009
<b>ONDA 801</b> Gear motor with built in T2E control unit. With electronic torque control.	500 kg uso resid 300 kg uso cond	64087542

IDEAL INSTALLATION	CODE
<b>ONDA 801 gear motor with built-in T2-E control unit.</b> With electronic torque control.	64087542
Pair of ER4N photocells	663510000008
One TR2 433,92 MHz twin-channel transmitter	62923000
Unico 433,92 MHz memory System radio receiver with antenna included	63394000
ET20N 230V flashing unit	64106000
Galvanised 4 PITCH Aprimatic rack completed with couplings	660150000009

DESCRIPTION OF OPTIONAL ACCESSORIES	CODE
PF 501/801 foundation plate (pack of 4 pcs)	63554821
TR2 433.92 MHz twin-channel transmitter	62923000
Pair of ER4N photocells	663510000008
PC12 key push button	64063000
CAL A aluminium column for the ER4N photocells	63450000
433,92 MHz antenna	62577000
Straight safety edge 1.5 m	661200000016
Straight safety edge 2.0 m	661200000017
Straight safety edge 3.0 m	661200000018
SB 500/800 Personalised release key	62945000

**NOTES:** For the control and safety devices, see pages 74-85. For the other installation accessories, see pages 86-87.